

# GD GROOVED 4.0/4.8



GD4.0-4.8FICHE

For installation information please refer to the tooling overview and manuals on our website [www.scell-it.com](http://www.scell-it.com)  
 Pour les conditions de pose, merci de vous référer à la description de l'outil et aux manuels disponibles sur notre site web.  
 Angaben zur Verarbeitung entnehmen Sie bitte der Geräteübersicht und den Betriebsanleitungen auf unserer Website.  
 Pro informace ohledně montáže navštivte naše webové stránky nebo nahlédněte do manuálu k nářadí.

ENGLISH	FRANÇAIS	DEUTSCH	CZECH
Mandrel : Steel	Tige : Acier	Dorn : Stahl	trn : Ocel
Body : Aluminium	Corps : Aluminium	Körper : Aluminium	ďřík : Hliník
Dome head	Tête plate	Flachrundkopf	plochá hlava

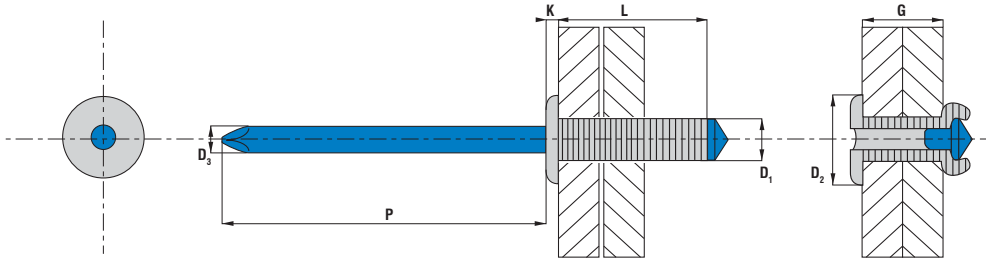

PART NO/REF	D <sub>1</sub>	L	D <sub>2</sub>	K	D <sub>3</sub>	P	G
	Ø (mm)	(mm)+1.0 / -0.2	Ø (mm)	(mm)	Ø (mm)	mini (mm)	min-max (mm)
GD4008	4.0 +0.35 / -0.0	8.0	8.0 -0.29 / +0.29	1.7	4.3	27.0	4.0
GD4010		10.0					6.0
GD4012		12.0					8.0
GD4016		16.0					12.0
GD4810	4.8 +0.35 / -0.0	10.0	9.5 -0.29 / +0.29	2.0	5.1	27.0	6.0
GD4811		11.0					7.0
GD4814		14.0					10.0
GD4816		16.0					12.0

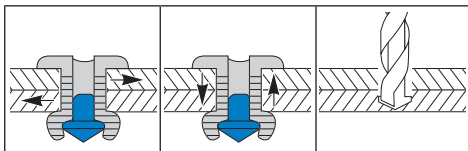

D <sub>1</sub> (mm)	(N)	(N)	Ø (mm)
4.0	885	1 410	4.3
4.8	1 185	1 575	5.1

**UNIT PLANT CERTIFICATES**

**Scell-it®**  
 Engineering & Development  
 © 2009 Blue future Intellectual Proterities

Data shown are subject to change without prior notice as a result of continuous product development and improvement policy.  
 Your local Scell-it representative is at your disposal should you need to confirm latest information.